

FLIPPER B

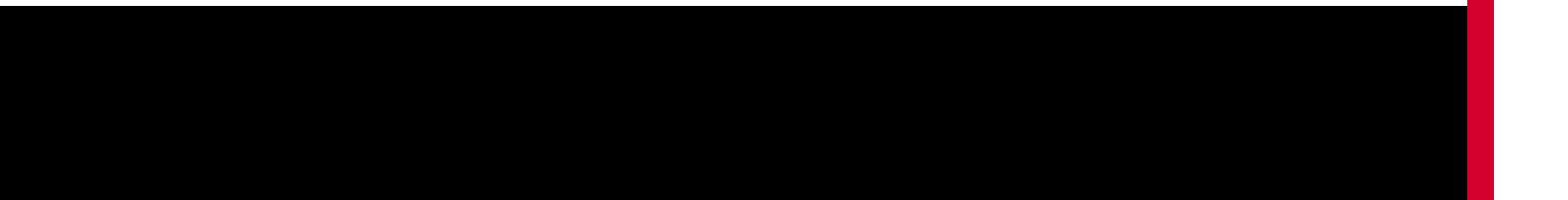



**FLIPPER-BI** is the new shelf support suitable for both wood and metal shelves. The shelf has to be pushed downwards onto the side dowels, which can be placed or screwed into any position required. The side dowels slot into the socket of the shelf supports and a click locks the shelf in position. To provide a structural fastening to the furniture screwed side dowels are required, so that the shelf flushes with the sides, due to the angled shape of the shelf support sockets. New stylish and highly captivating squared shape.

Available for:  
 - min. 18mm thick wood shelves  
 - min. 15,5mm thick metal shelves



## ASSEMBLING

1

INSERT THE FLIPPER-BI SUPPORT INTO THE WOOD SHELF

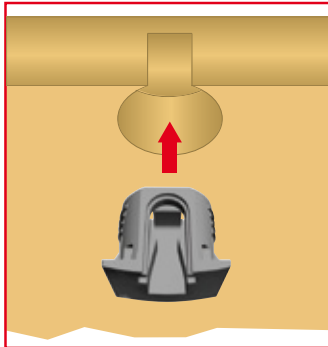

INSERT THE FLIPPER-BI SUPPORT INTO THE METAL SHELF

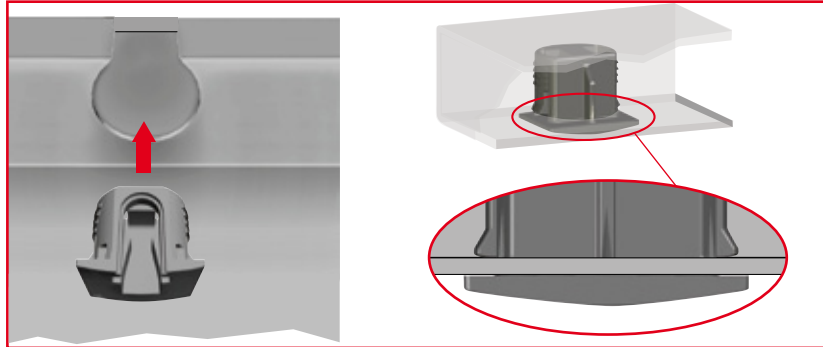

ASSEMBLING WITH SMOOTH PIN

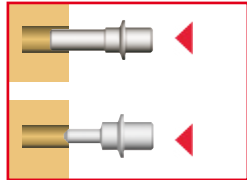

ASSEMBLING WITH THREADED PIN TO ACHIEVE HORIZONTAL CONNECTION

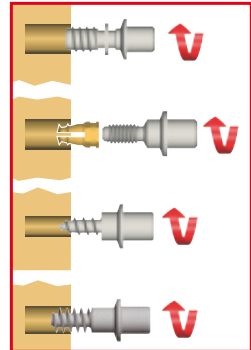

2

INSERT THE SHELF DIAGONALLY INTO THE CABINET (ALSO WITH DOOR ALREADY ASSEMBLED)

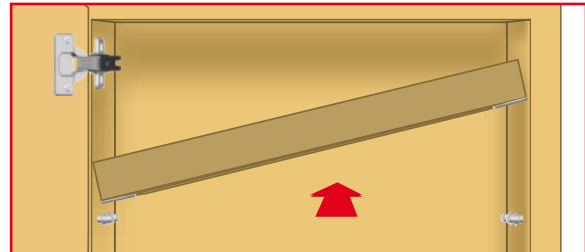

3

PLACE THE SHELF OVER THE PINS

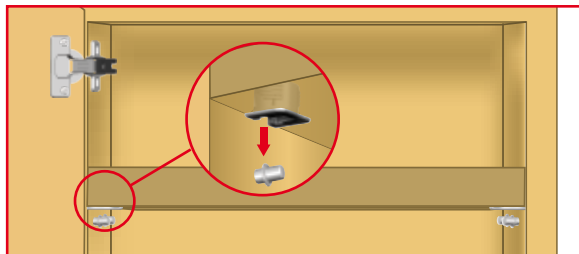

4

PRESS THE SHELF DOWN

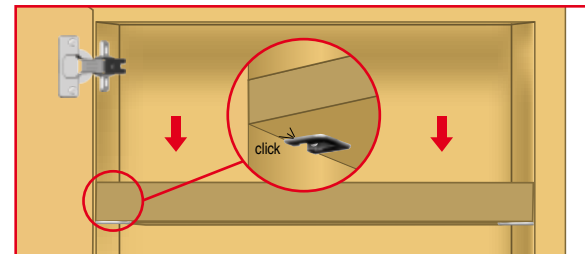

## SHELF REMOVAL AND REPOSITIONING

SHELF REMOVAL  
 PUSH THE SHELF UPWARDS FOR RELEASE

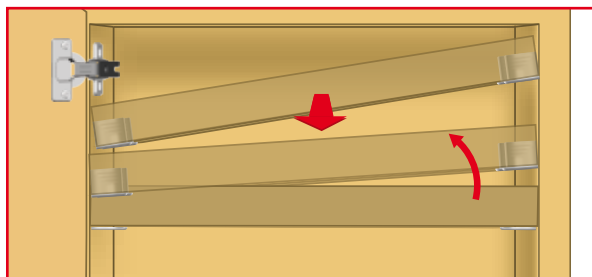

SHELF REPOSITIONING  
 TO REPOSITION THE SHELF REPEAT OPERATIONS AS SHOWN IN PCS.2-3-4.

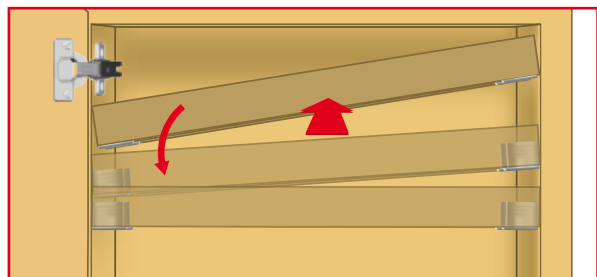

**SUPPORT FOR FLIPPER-BI, WOOD SHELVES 18mm MIN. THICKNESS**

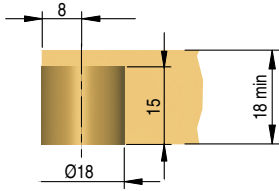

Engineering plastic

Part. no	Finish
10601040IL	Grey

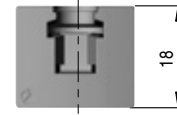

**SUPPORT FOR FLIPPER-BI, METAL SHELVES 15,5mm MIN. THICKNESS**

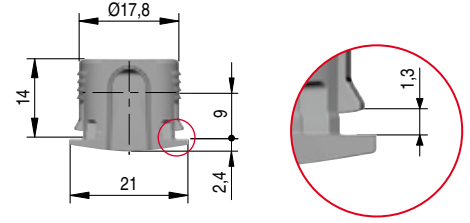
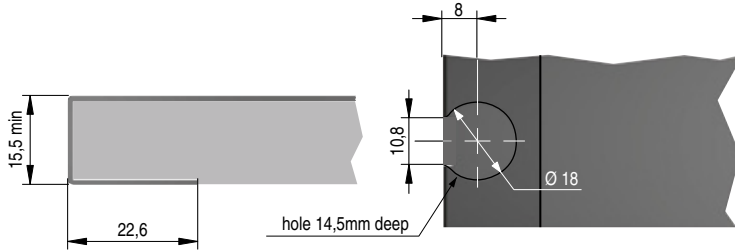

**DOWEL FOR FLIPPER-BI**

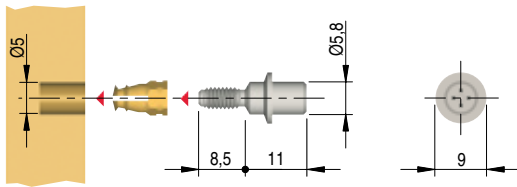

For M4 spreading dowel  
Steel

Part. no	Finish
10602010ZN	Zinc-plated

**DOWEL FOR FLIPPER-BI**

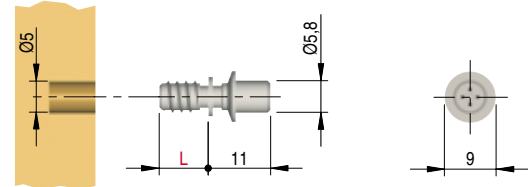

Ø 5mm euro screw  
Steel

L	Part. no	Finish
8,8	10604010ZN	Zinc-plated
7,8	10604020ZN	Zinc-plated

**DOWEL FOR FLIPPER-BI**

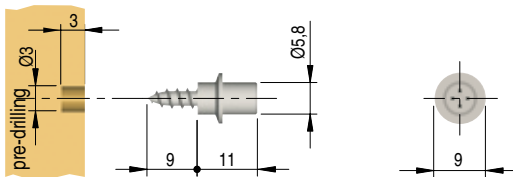

Ø 3mm screw  
Steel

Part. no	Finish
10603010ZN	Zinc-plated

**DOWEL FOR FLIPPER-BI**

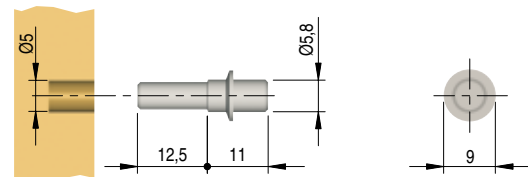

With smooth pin Ø 5mm  
Steel

Part. no	Finish
10605020ZN	Zinc-plated

**DOWEL FOR FLIPPER-BI**

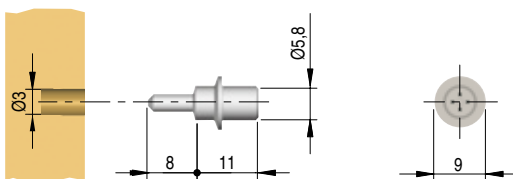

Available on request  
With smooth pin Ø 3mm  
Steel

Part. no	Finish
10605030ZN	Zinc-plated

**DOWEL FOR FLIPPER-BI**

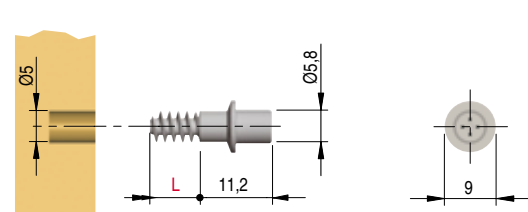

Removable  
threaded bolt  
Steel

L	Part. no	Finish
9,7	10606020ZN	Zinc-plated
7,7	10606010ZN	Zinc-plated



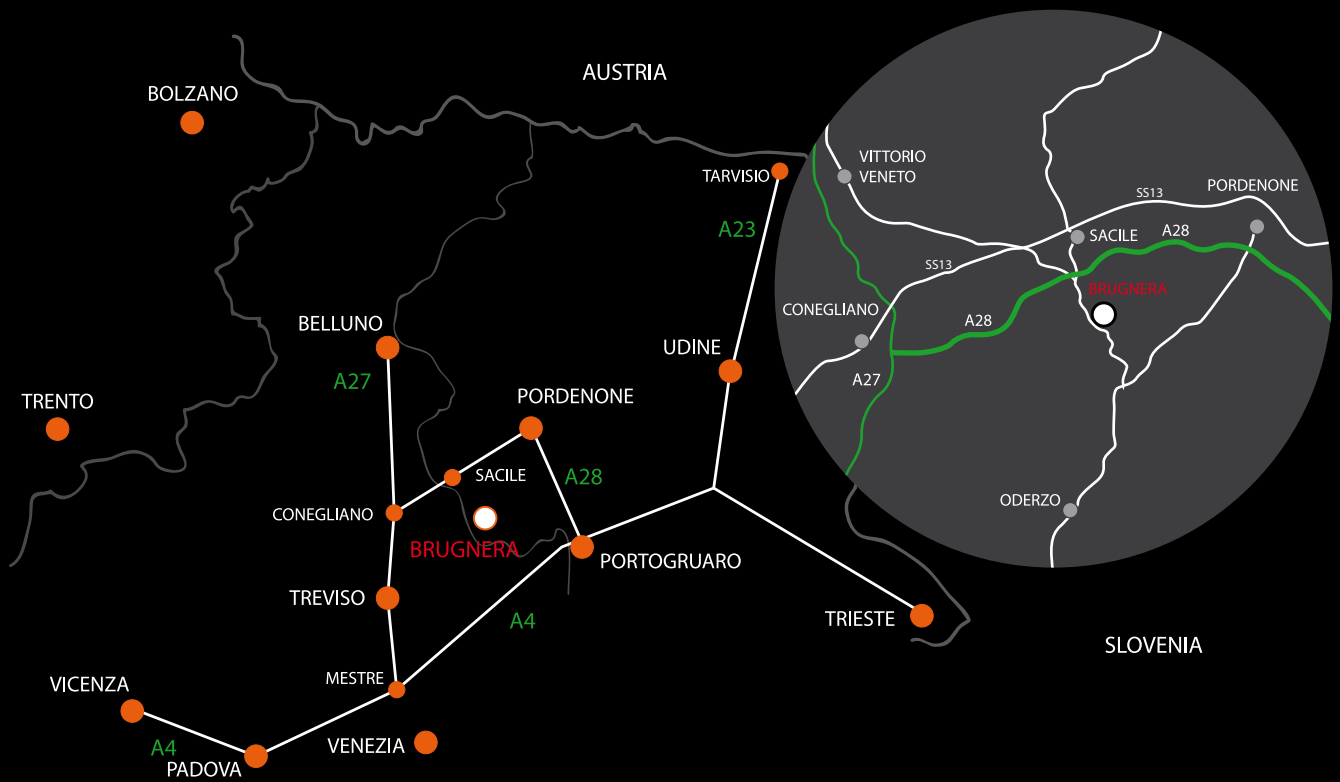

**ITALIANA FERRAMENTA**

Via Taglio n° 87 I - 33070 Maron di Brugnera (PN) Tel. +39 0434 428211 Fax +39 0434 428242 [www.italianaferramenta.com](http://www.italianaferramenta.com) [info@italianaferramenta.it](mailto:info@italianaferramenta.it)