

PK2 SIDE BRACKET ROUND LEDGE



SHELF  
SUPPORTS



# SYMBOLS AND FINISHES LEGEND

## SYMBOLS

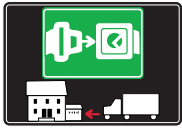

= SHELF SAFELY LOCKED DURING TRANSPORTATION AND AT HOME.



= ANTI-TURNOVER LOCKING SYSTEM



= NORMS / PATENTS



= PHILLIPS / POZIDRIV



= NEWTON



= PART.NO



= HEXAGONAL SOCKET



= FRICTION



= PCS. PER PACKAGE



= BLADE SLOT



= AUTOMATIC



= COMBI SLOT



= DROP DOWN



= CAPACITY LOADING



= COUNTERSUNK HEAD



= WOOD / GLASS THICKNESS



= PAN HEAD



= STANDARD HINGE



= HOLE DIAMETER



= FLANGE HEAD



= KIMANA HINGE



= DIAMETER



= FLAT HEAD



= FLAP HINGE



= LENGTH



= TRILOBULAR SCREW



= WITH SPRING



= HEIGHT



= SELF-TAPPING SCREW



= WITHOUT SPRING



= RIGHT VERSION



= EURO THREAD



= REVERSED SPRING



= LEFT VERSION



= METRIC THREAD



= SETTING CODE



= PRE-INSERTED SCREW



= FOR ROUND TUBE



= PCS. PER PAD



= PRE-INSERTED SCREW AND SPREADING BUSH



= FOR OVAL TUBE



= CUT ON REQUEST



= WITH BUFFER



= SELF ADHESIVE



= WITH MAGNET



= WITH FLANGE

NOTE: Printing errors and omissions may exist despite our best efforts to ensure accuracy. We reserve the right to alter specifications without notice.

## MATERIALS

|  |                                 |                               |                   |  |
|--|---------------------------------|-------------------------------|-------------------|--|
| <b>ZA</b> = Zinc Alloy                 | <b>ST</b> = Steel               | <b>HSS</b> = High Speed Steel | <b>BR</b> = Brass | <b>ABS</b> = Acrylonitrile Butadiene Styrene |
| <b>ZAnk</b> = Nickel-plated Zinc Alloy | <b>STzk</b> = Zinc-plated Steel | <b>AL</b> = Aluminium         | <b>WD</b> = Wood  | <b>EVA</b> = Ethylene Vinyl Acetate          |

**EP** = **ENGINEERING PLASTIC**

+ **EP** = other engineering plastic available on request

**SR** = **SOFT RUBBER**

+ **SR** = other soft rubber available on request

|   |  |                                  |
|---|--|----------------------------------|
| <b>EPn</b> = Natural Engineering Plastic      | <b>EPc</b> = Clear Engineering Plastic | <b>SRn</b> = Natural Soft Rubber |
| <b>EPw</b> = White Engineering Plastic        | <b>EPg</b> = Grey Engineering Plastic  | <b>SRw</b> = White Soft Rubber   |
| <b>EPwg</b> = Water Green Engineering Plastic |  | <b>SRb</b> = Black Soft Rubber   |



## FINISHES



+ = OTHER FINISHES AVAILABLE ON REQUEST

|    |               |    |                          |    |                              |
|----|---------------|----|--------------------------|----|------------------------------|
| AA | Natural       | JB | Bright Aluminium         | QB | Walnut                       |
| AB | White         | JC | Aluminium - Chrome       | RO | Red                          |
| AC | Opal White    | JD | Matt Aluminium           | UZ | T -Met                       |
| AE | White 9010    | JE | Satin-finished Aluminium | WA | Bronzed                      |
| AK | Champagne     | JF | Aluminium - Brass        | WI | Burnished                    |
| AL | Ivory         | JG | Aluminium 5              | XD | Satin-finished Steel         |
| EA | Black         | JL | Aluminium PE 11          | YA | Nickel-plated                |
| EB | Glossy Black  | JM | Aluminium RAL 9006       | YB | Bright Nickel-plated         |
| EC | Matt Black    | KA | Chrome                   | YC | Matt Nickel-plated           |
| EE | Anthracite    | KB | Bright Chrome            | YD | Satin-finished Nickel-plated |
| FU | Gunmetal      | KC | Matt Chrome              | ZA | Zinc alloy                   |
| GR | Raw           | MA | Brown                    | ZN | Zinc-plated                  |
| HA | Brass-Plated  | MB | Light Brown 1            | ZQ | Bright Gold                  |
| HH | Tropicalized  | NN | Metallic Beige           | ZY | Titanium                     |
| HL | Raw Brass     | NO | Beige                    | ZZ | Clear                        |
| IA | Grey          | OA | Oak                      | 00 | Insignificant finish         |
| IB | Metallic Grey | OZ | Ash                      |    |                              |
| IF | Middle Grey   | PA | Light Ash                |    |                              |
| IJ | Light Grey    | PZ | Beech                    |    |                              |
| IL | Grey 20       | QA | Maple                    |    |                              |



## PK2 FOR 18 - 19 mm SHELF SIDE BRACKET ROUND LEDGE

New connecting fitting for the complete cabinet construction (base shelves and top) providing structural fastening.

Suitable for heavy duty wardrobes, bookcases, modular furniture, office furniture and dismantled furniture (Do It by Yourself).

Available for 18 - 19 mm thick panels minimum.

Consists of two separate parts: zinc alloy side bracket and plastic shelf support with zinc alloy minifix inside to be slotted into the shelf.

Shelf is subsequently vertically pressed and clicks onto the side bracket.

The rounded side bracket ledge can flush with the lower side of the shelf, by operating a face boring, making the result aesthetically very elegant.

Shelf and top panel connection to be carried out by turning the mini fix 90° from the under side.

Optional through hole Ø8 mm for connecting also the bottom panel to be carried out by turning the minifix 90° from the upper side.

Side bracket available as plain version for euro screw,

countersunk screw, M4 dowel with spreading dowel or with pre-inserted spreading bush and screw for shelf repositioning without damaging the hole.

A plastic cover cap can be used to conceal the housing on the bottom.

In accordance with the European regulations UNI EN 14749/05.



18 - 19 mm min.

UNI EN 14749/05 and UNI 8603/05

### INSTALLATION AND ASSEMBLING

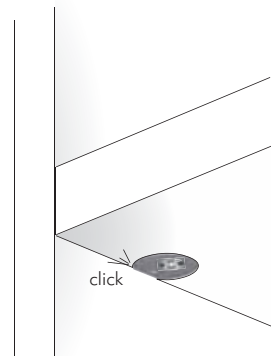
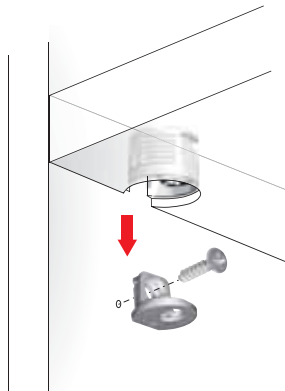
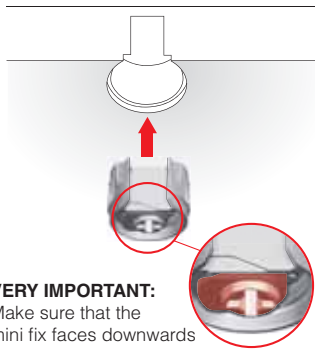

### STRUCTURAL FASTENING WITH CROSS PZ2 SCREWDRIVER:

90° turning from the upper side, for the furniture floor.

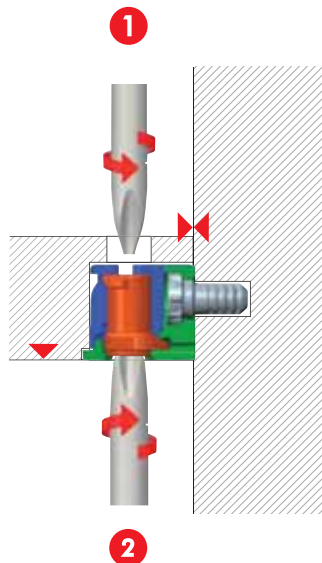

90° turning from the lower side, for the shelves and for the top.

Assembling with alternative fixing options.

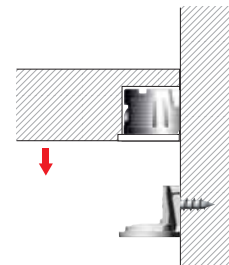

Assembling with pre-inserted spreading bush and screw to avoid hole damaging for shelf repositioning.

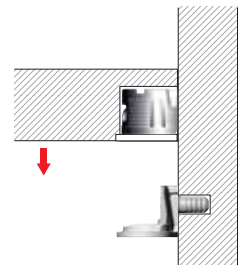

### LOCKING DETAIL:

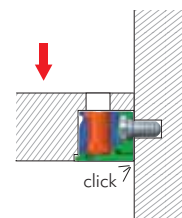

After turning the minifix.

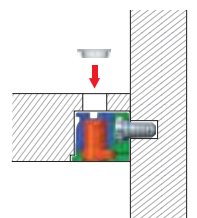

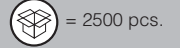
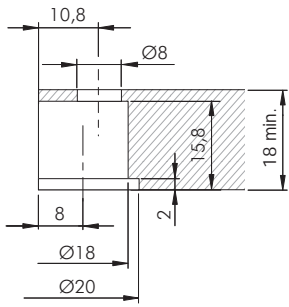

11401010J

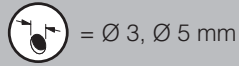
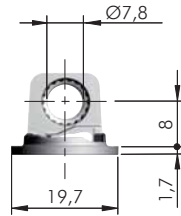
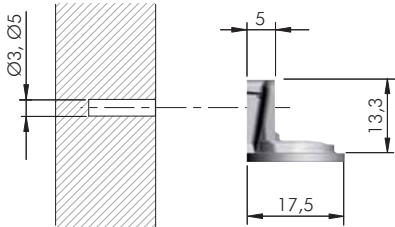

11402110YA

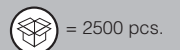
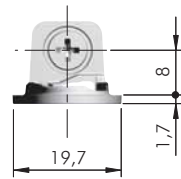
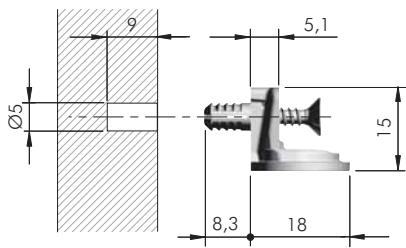

11402120YA

**DRILL BIT FOR PK2 SIDE BRACKET ROUND LEDGE**

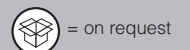
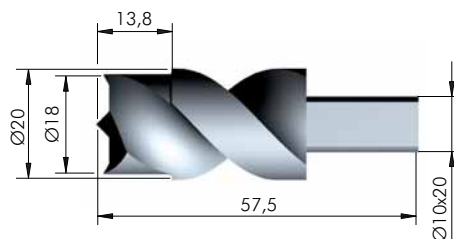
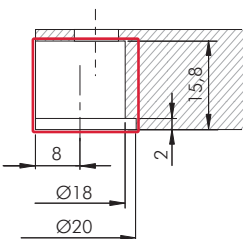

1145203000

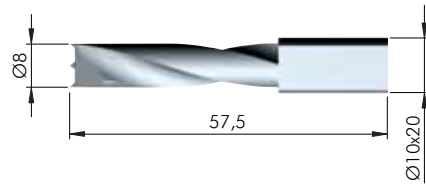
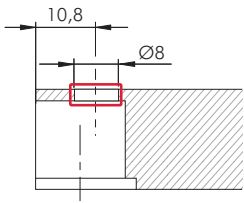

HSS = on request

|

1145202000

## PK2 SIDE BRACKET ROUND LEDGE ACCESSORY

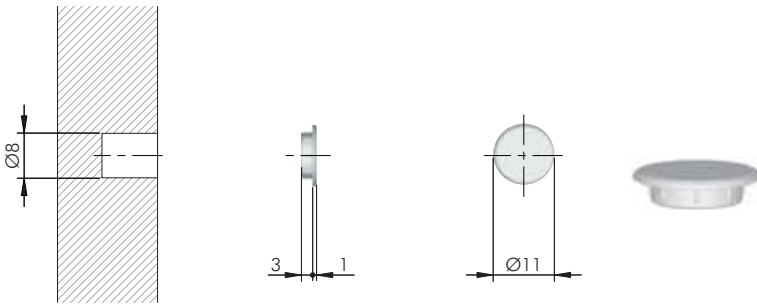

= Ø 8 mm

EP = 5000 pcs.

|

23002010AB

## PK2 SIDE BRACKET ROUND LEDGE FIXING ACCESSORIES

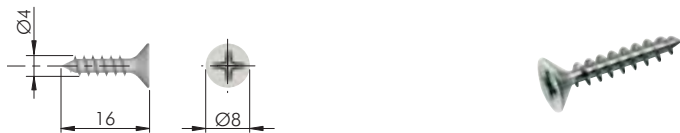

= Ø 3 mm

= PZ2

ST = 5000 pcs.

|

60101570ZN

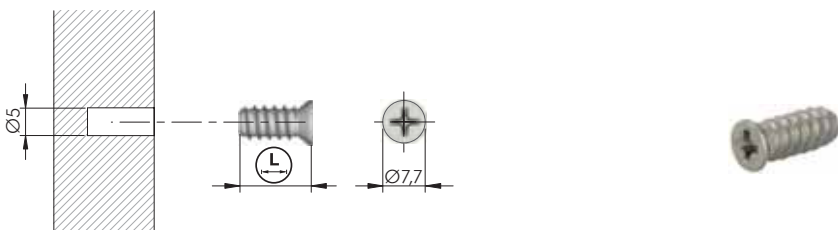

= Ø 5 mm

= PZ2

ST

|  |            |      |      |
|--|------------|------|------|
|  | 60502010ZN | 10   | 9000 |
|  | 60501050YA | 12,7 | 5000 |
|  | 60502020ZN | 13   | 5000 |
|  | 60502030ZN | 15   | 5000 |

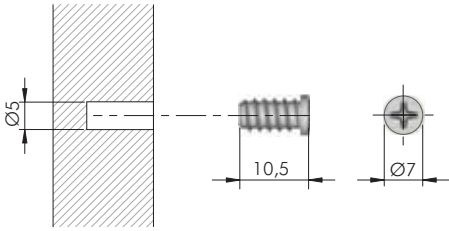

= Ø 5 mm +

= PZ2

ST  = 5000 pcs.



60507010YA

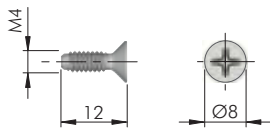

= M4 = PZ2

ST  = 2000 pcs.



60305040ZN

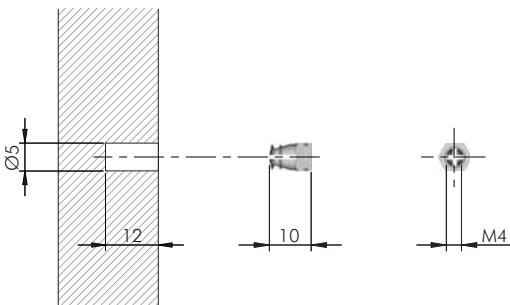

= Ø 5 mm = M4

BR  = 20.000 pcs.



20502021HL

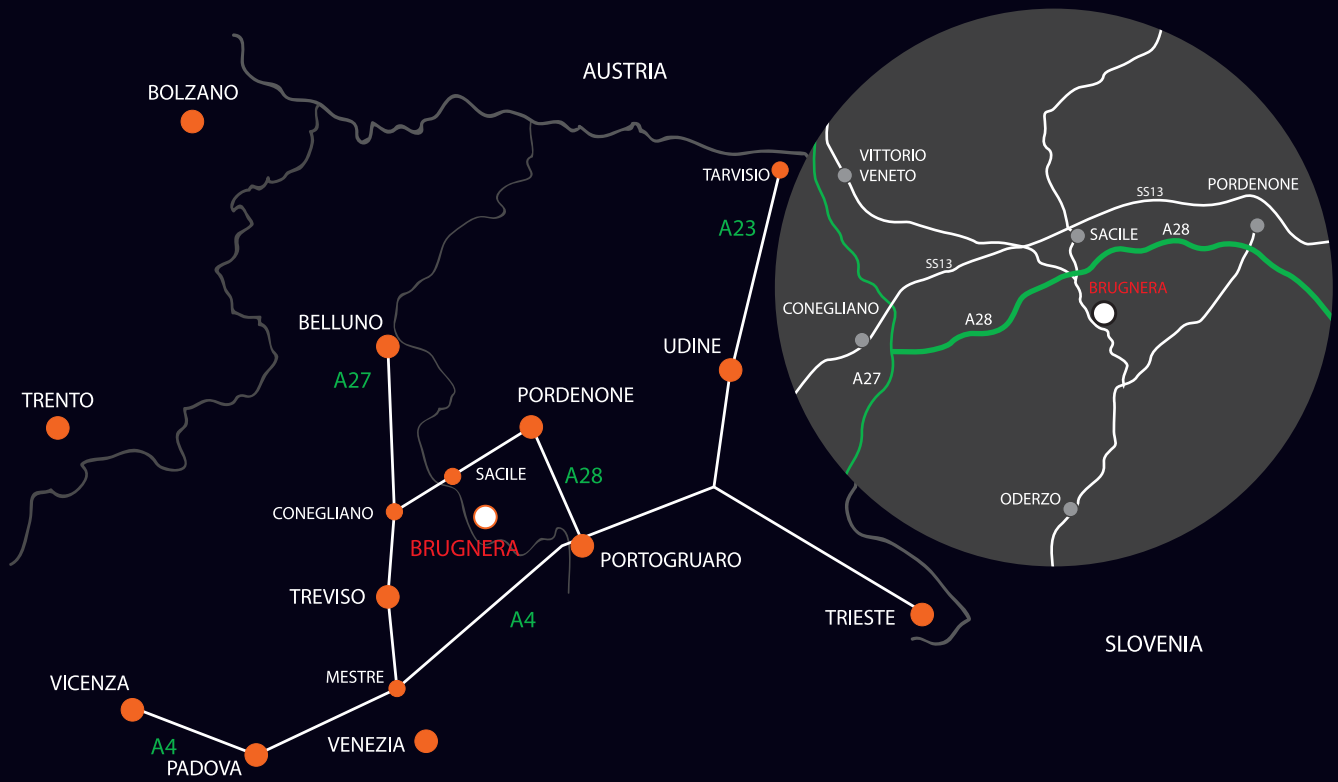

[www.italianaferramenta.com](http://www.italianaferramenta.com)